



# City of Chicago



O2018-7739

Office of the City Clerk

## Document Tracking Sheet

<b>Meeting Date:</b>	9/20/2018
<b>Sponsor(s):</b>	Quinn (13)
<b>Type:</b>	Ordinance
<b>Title:</b>	Designation of 30th Precinct of 13th Ward as Restricted Residential Zone prohibiting additional shared housing units and vacation rentals
<b>Committee(s) Assignment:</b>	Committee on License and Consumer Protection

50

**ORDINANCE**



**WHEREAS**, Chapter 4-17 of the Municipal Code of Chicago authorizes the establishment of Restricted Residential Zones pursuant to an opt-out process, which requires a petition to trigger an ordinance; and

**WHEREAS**, The requisite procedural requirements have been met; now, therefore,

**BE IT ORDAINED BY THE CITY COUNCIL OF THE CITY OF CHICAGO:**

**SECTION 1.** Pursuant to Sections 4-17-020 and 4-17-040 of the Municipal Code of Chicago ("Code"), the 30th Precinct of the 13th Ward, as described herein, is hereby designated as a Restricted Residential Zone within the meaning of Chapter 4-17 of the Code. All new or additional shared housing units and vacation rentals shall be prohibited within the boundaries of such 30th Precinct, with such boundaries beginning at the southeast intersection of South Hamlin Avenue and West 65th Place, thence east on the south side of West 65th Place to the east side of South Central Park Avenue, thence north on the east side of South Central Park Avenue to the south side of West 65th Street, thence east on the south side of West 65th Street to the Grand Trunk R.R., thence south on Grand Trunk R.R. to the north side of West 68th Street (extended), thence west on the north side of West 68th Street and West 68th Street (extended) to the east side of South Lawndale Avenue, thence north on the east side South Lawndale Avenue to the north side of West Marquette Road, thence west on the north side of West Marquette Road to the east side of South Hamlin Avenue, and thence north on the east side of South Hamlin Avenue to the place of beginning.

**SECTION 2.** This ordinance shall take full force and effect upon its passage and publication, and shall remain in effect for four years following its effective date.



---

Alderman Marty Quinn, 13<sup>th</sup> Ward









**PCT 30    WARD 13**

Beginning at the intersection of S. Hamlin Av. and W. 65<sup>th</sup> Pl., thence east on W. 65<sup>th</sup> Pl. to S. Central Park Av., thence north on S. Central Park Av. to W. 65<sup>th</sup> St., thence east on W. 65<sup>th</sup> St. to the Grand Trunk R.R., thence south on Grand Trunk R.R. to W. 68<sup>th</sup> St. (extended), thence west on W. 68<sup>th</sup> St. and W. 68<sup>th</sup> St. (extended) to S. Lawndale Av., thence north on S. Lawndale Av. to W. Marquette Rd., thence west on W. Marquette Rd. to S. Hamlin Av., and thence north on S. Hamlin Av. to the place of beginning.

# PCT 30 WARD 13



## Legend

-  Precinct Boundary
-  Freeway
-  Major Street
-  Local Street
-  Service Drive
-  Ramp
-  Alley
-  Streams
-  Railroad

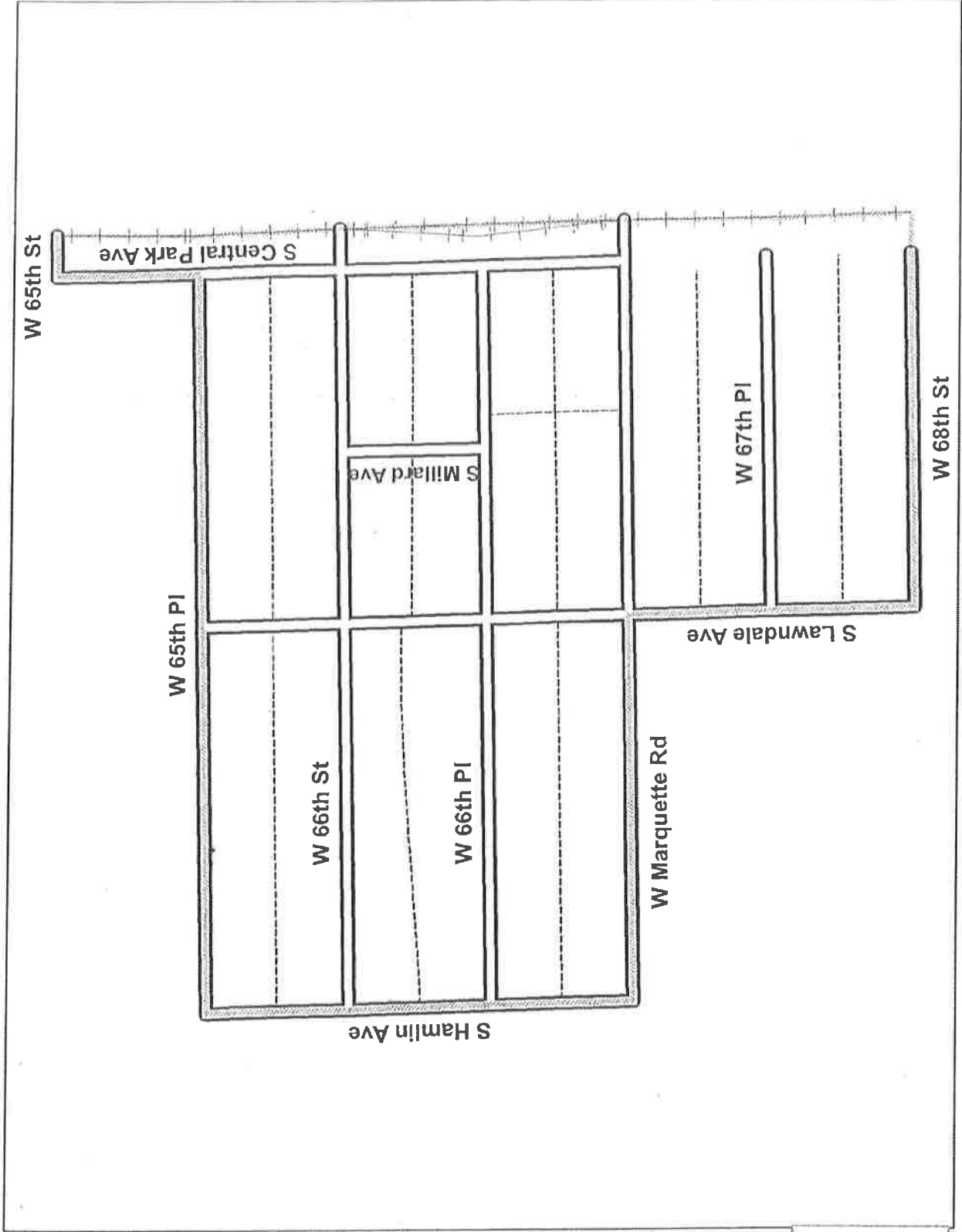

Board of Elections  
 City of Chicago  
 69 W Washington, Suite 600  
 Chicago, IL 60602  
 312-269-7900  
[www.chicagoelections.com](http://www.chicagoelections.com)

September 19, 2012



430 Feet