



RECEIVED #1

2020 AUG 27 PM 12:12

OFFICE OF THE CITY CLERK

CITY OF CHICAGO ANNA VALENCIA

OFFICE OF THE CITY CLERK

NOTICE OF INTENT FORM

1. Submit a complete and accurate description of the precinct you wish to restrict.

The description of the precinct boundaries of the 26 Precinct of the 11 Ward of the City of Chicago in the County of Cook and the State of Illinois, as such precinct existed as of the last General Election, is as follows:

[Empty box for precinct description]

2. Please select the scope of restriction sought for the 26 Precinct of the 11 Ward:

A: Restricting Shared Housing Units and Vacation Rentals

- Restrict all new or additional shared housing units AND vacation rentals.
Restrict all new or additional shared housing units.
Restrict all new or additional vacation rentals.

OR

B: Restricting Shared Housing Units and Vacation Rentals that are NOT their owner's Primary Residence:

- Restrict all new or additional shared housing units AND vacation rentals that ARE NOT their owner's or tenant's primary residence.
Restrict all new or additional shared housing units that ARE NOT their owner's or tenant's primary residence
Restrict all new or additional vacation rentals that ARE NOT their owner's or tenant's primary residence.

KEN ZEKICH
Petitioner Name

[Signature]
Signature

8-21-20
Date

# PCT 26 WARD 11



## Legend

-  Precinct Boundary
-  Freeway
-  Major Street
-  Local Street
-  Service Drive
-  Ramp
-  Alley
-  Streams
-  Railroad

Board of Elections  
 City of Chicago  
 69 W Washington, Suite 600  
 Chicago, IL 60602  
 312-269-7900

[www.chicagoelections.com](http://www.chicagoelections.com)

September 19, 2012  
 August 20, 2013

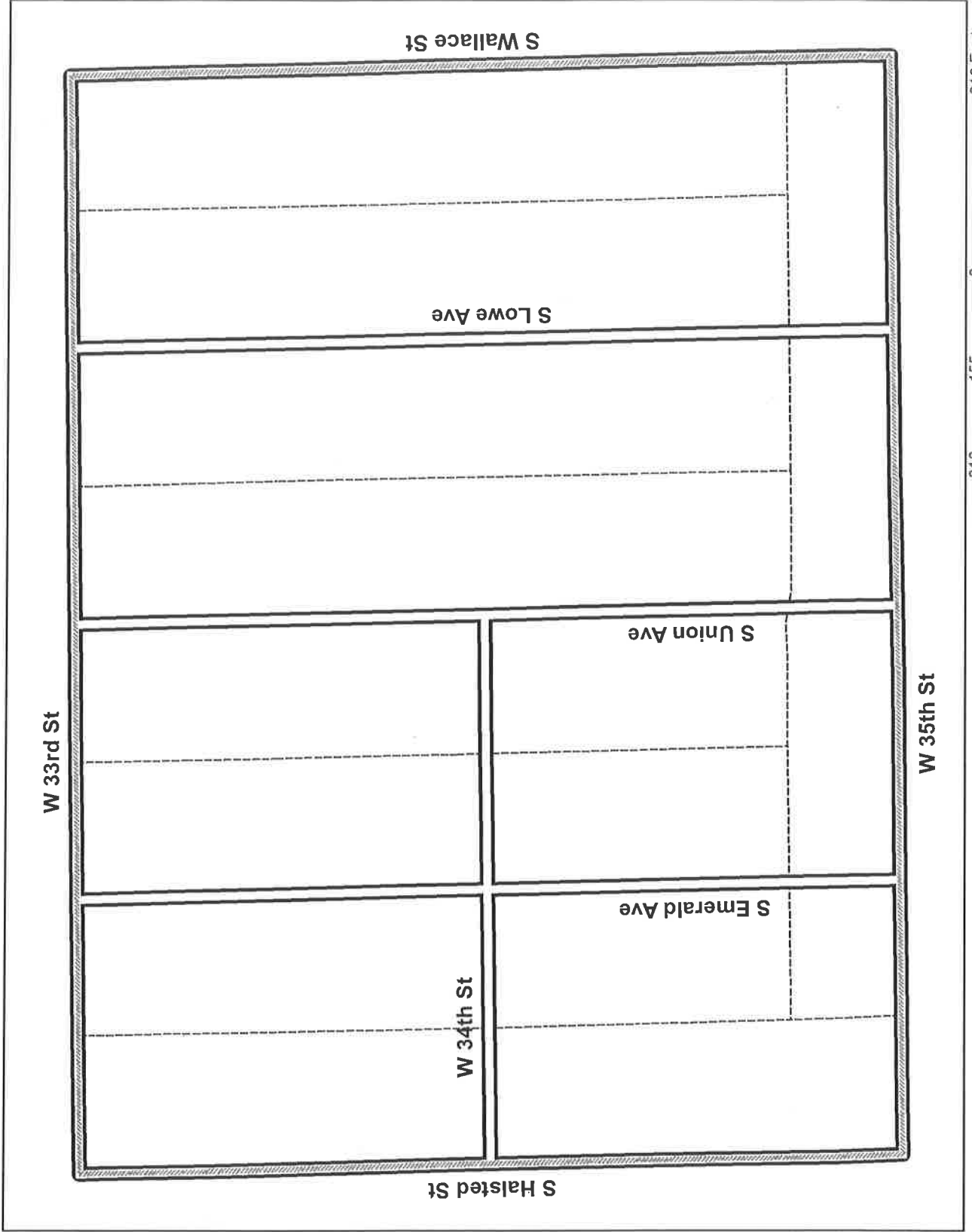

310 155 0 310 Feet

**PCT 26    WARD 11**

Beginning at the intersection of S. Halsted St. and W. 33<sup>rd</sup> St., thence east on W. 33<sup>rd</sup> St. to S. Wallace St., thence south on S. Wallace St. to W. 35<sup>th</sup> St., thence west on W. 35<sup>th</sup> St. to S. Halsted St., and thence north on S. Halsted St. to the place of beginning.