

RECEIVED
#3



2017 APR 11 AM 11:14

OFFICE OF THE
CITY CLERK

OFFICE OF THE CITY CLERK
CITY OF CHICAGO
ANNA VALENCIA

ML
~~17 APR 10 PM 11:09
OFFICE OF THE
CITY CLERK
RECEIVED~~

NOTICE OF INTENT FORM

1. Submit a complete and accurate description of the precinct you wish to restrict.

The description of the precinct boundaries of the 23 Precinct of the 23 Ward of the City of Chicago in the County of Cook and the State of Illinois, as such precinct existed as of the last General Election, is as follows:

Please see attached.

2. Please select the scope of restriction sought for the 23 Precinct of the 23 Ward:

A: Restricting Shared Housing Units and Vacation Rentals

- Restrict all new or additional *shared housing units AND vacation rentals*.
- Restrict all new or additional *shared housing units*.
- Restrict all new or additional *vacation rentals*.

OR

B: Restricting Shared Housing Units and Vacation Rentals that are NOT their owner's Primary Residence:

- Restrict all new or additional *shared housing units AND vacation rentals* that **ARE NOT** their owner's or tenant's primary residence.
- Restrict all new or additional *shared housing units* that **ARE NOT** their owner's or tenant's primary residence
- Restrict all new or additional *vacation rentals* that **ARE NOT** their owner's or tenant's primary residence.

Matthew Skora
Petitioner Name

Matthew Skora
Signature

04/11/17
Date







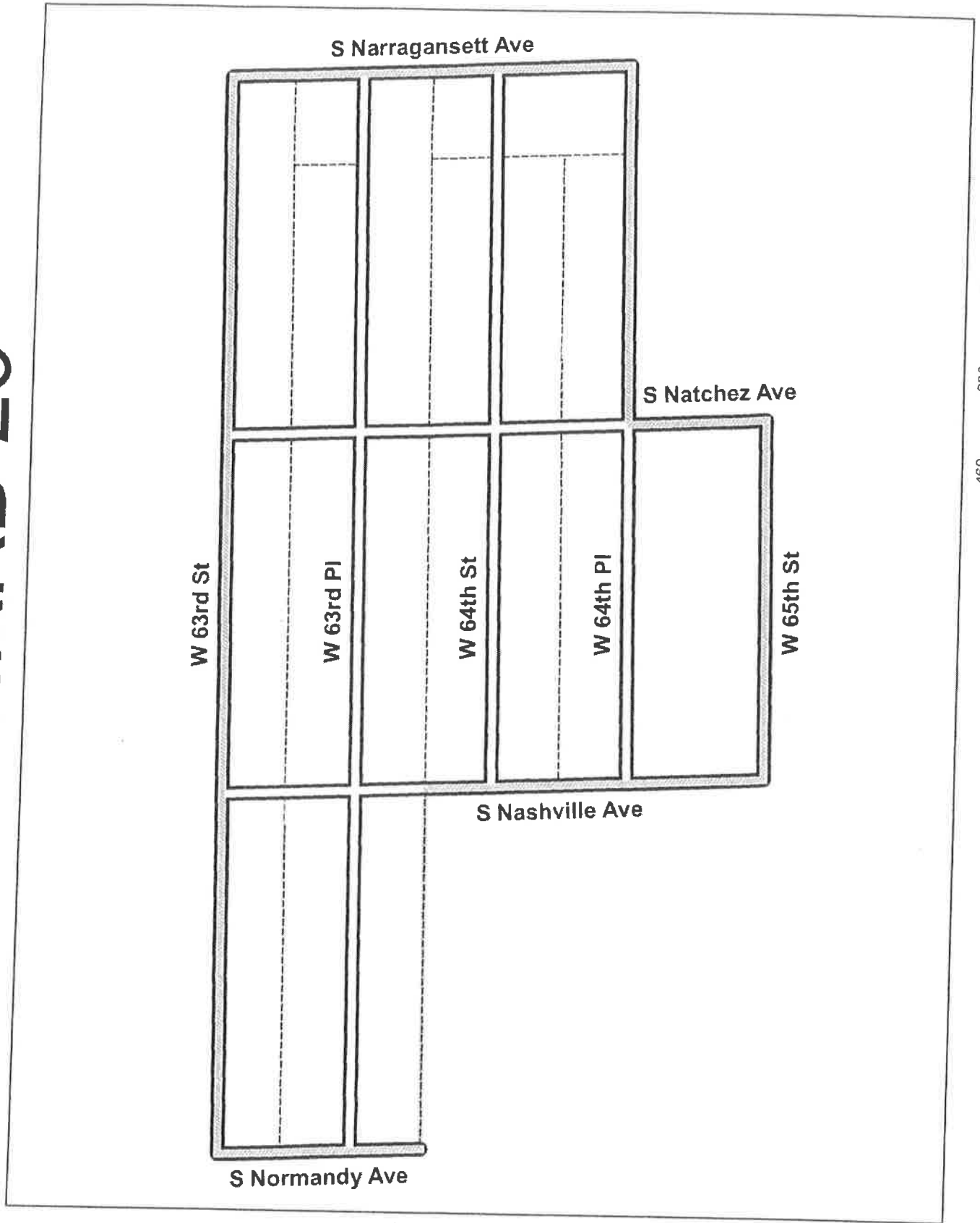

PCT 23 WARD 23

Beginning at the intersection of S. Normandy Av. and W. 63rd St., thence east on W. 63rd St. to S. Narragansett Av., thence south on S. Narragansett Av. to W. 64th Pl., thence west on W. 64th Pl. to S. Natchez Av., thence south on S. Natchez Av. to W. 65th St., thence west on W. 65th St. to S. Nashville Av., thence north on S. Nashville Av. to the alley south of W. 63rd Pl., thence west on the alley south of W. 63rd Pl. to S. Normandy Av., and north on S. Normandy Av. to the place of beginning.

PCT 23 WARD 23

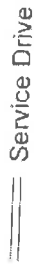

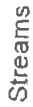
Legend

-  Precinct Boundary
-  Freeway
-  Major Street
-  Local Street
-  Service Drive
-  Ramp
-  Alley
-  Streams
-  Railroad

Board of Elections
 City of Chicago
 69 W Washington, Suite 600
 Chicago, IL 60602
 312-269-7900
www.chicagoelections.com

September 19, 2012

