



OFFICE OF THE CITY CLERK
CITY OF CHICAGO
ANNA VALENCIA

2018 JUN -6 AM 11:03
OFFICE OF THE
CITY CLERK

NOTICE OF INTENT FORM

1. Submit a complete and accurate description of the precinct you wish to restrict.

The description of the precinct boundaries of the 44 Precinct of the 13 Ward of the City of Chicago in the County of Cook and the State of Illinois, as such precinct existed as of the last General Election, is as follows:

please see attached.

2. Please select the scope of restriction sought for the 44 Precinct of the 13 Ward:

A: Restricting Shared Housing Units and Vacation Rentals

- Restrict all new or additional *shared housing units AND vacation rentals*.
- Restrict all new or additional *shared housing units*.
- Restrict all new or additional *vacation rentals*.

OR

B: Restricting Shared Housing Units and Vacation Rentals that are NOT their owner's Primary Residence:

- Restrict all new or additional *shared housing units AND vacation rentals* that ARE NOT their owner's or tenant's primary residence.
- Restrict all new or additional *shared housing units* that ARE NOT their owner's or tenant's primary residence
- Restrict all new or additional *vacation rentals* that ARE NOT their owner's or tenant's primary residence.

Jessica Molina
Petitioner Name

Jessica Molina
Signature

6/6/18
Date







PCT 44 WARD 13

Beginning at the intersection of S. Komensky Av. and W. 67th St./ W. Marquette Rd., thence east on W. 67th St./W. Marquette Rd. to S. Lawndale Av., thence south on S. Lawndale Av. to W. 68th St., thence west on W. 68th St. to S. Hamlin Av., thence south on S. Hamlin Av. to W. 68th Pl., thence west on W. 68th Pl. to S. Springfield Av., thence south on S. Springfield Av. to W. 69th St., thence west on W. 69th St. to S. Pulaski Rd., thence north on S. Pulaski Rd. to W. 68th St., thence west on W. 68th St. to S. Komensky Av., and thence north on S. Komensky Av. to the place of beginning.

PCT 44 WARD 13



Legend

-  Precinct Boundary
-  Freeway
-  Major Street
-  Local Street
-  Service Drive
-  Ramp
-  Alley
-  Streams
-  Railroad

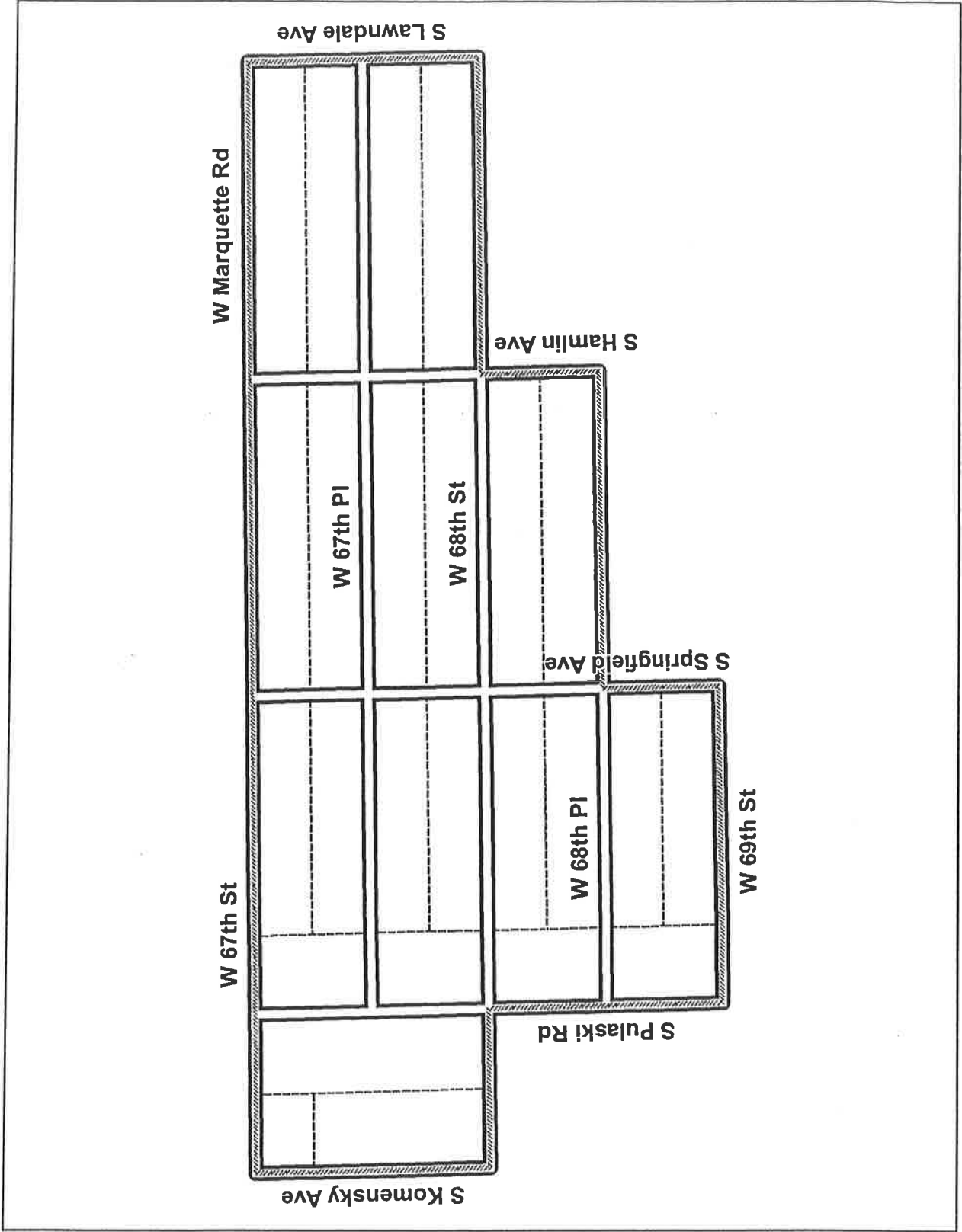

Board of Elections
 City of Chicago
 69 W Washington, Suite 600
 Chicago, IL 60602
 312-269-7900
www.chicagoelections.com

September 19, 2012

